

JP AR-15 Tension Pin

Parts Included:

- Tension pin
- 9/64" hex key (JPTP-1)
- 1/8" hex key (JPTP-2)

CAUTION: REMOVE MAGAZINE AND VISUALLY CHECK CHAMBER TO MAKE SURE THAT FIREARM IS UNLOADED.

Remove the butt stock from your lower assembly and be careful not to lose the takedown pin detente plunger and spring which will protrude from the back of the lower receiver. Remove the plunger, spring and take down pin and store for future use. Unscrew the cross bolt of the tension pin and apply a small amount of some non-permanent thread locking agent such as Loctite 242 to the inside of the threaded section of the wedge to prevent the device from loosening while firing. Insert the JP Tension Pin from the left side of the receiver by using the allen key to hold it and inserting the slotted end first. Position the slotted end with the orange reference dot at the 12:00 position on the right side of the receiver to ensure proper orientation. See Figure A. Note the position of the center "floating" compression wedge piece and make sure it is orientated back and down (towards the web between the grip and stock) when inserting the pin. See Figure B.

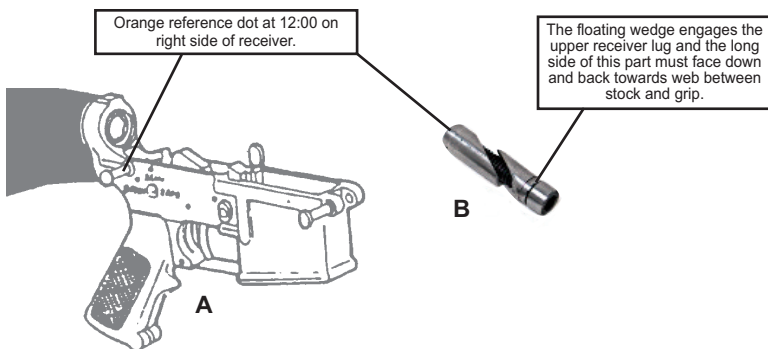

Now using the provided allen key, tension the device and if it is properly installed, the upper assembly will be pulled back and down on the lower with no remaining play. It may be necessary to use an appropriate screw driver on the slotted end

while tensioning with the key to prevent it from slipping. Do not over tension as this will eventually cause the floating wedge piece to “mushroom” making it difficult to remove and insert the pin even in its de-tensioned condition. If this happens, clean up the edges of the wedge pieces with a small file. If you ruin a tension pin or wear one out, we'll replace it for only \$15.00, postage paid.

THANKS FOR YOUR BUSINESS!